



### F/F full port ball valve

F/F full port ball valve in hot forged brass.  
Stem gland seal system.  
Nickel plate finish.  
Ends threaded to ISO 228 (DIN 259 BSP 2779).  
Provided with steel T-handle.

**PN 30. Max Temperature 150°C.**  
**Dimensions: from 1/4" up to 1"1/4.**

#### Dimensional specifications:

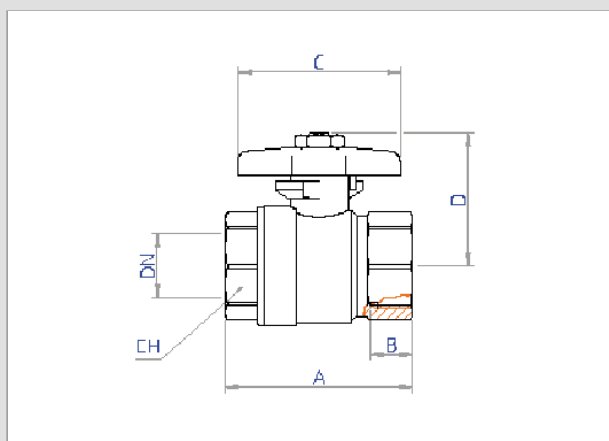

Specifications	Dimensions					
	1/4"	3/8"	1/2"	3/4"	1"	1"1/4"
A	44	44	50	58	68	80
B	12	12	12	13	15	17
C	50	50	50	50	60	60
D	36	36	38	41	47	52
CH	20,5	20,5	25	31	38,5	47,5
DN	10	10	15	20	25	32
Weight [g]	144	130	199	279	438	670

Code 1/4": **0051F**      Code 3/4": **0351F**  
Code 3/8": **0151F**      Code 1": **0451F**  
Code 1/2": **0251F**      Code 1"1/4": **0551F**

#### Correlated articles

##### SigilBlock



Patented tamperproof device

##### SigilBlock key



SigilBlock unlocking key